

## contribution form

I would like to support the Bodhi Eco Project

Full Name \_\_\_\_\_

Address \_\_\_\_\_

Postcode \_\_\_\_\_

Telephone \_\_\_\_\_

E-mail \_\_\_\_\_

Skills I can offer \_\_\_\_\_

\_\_\_\_\_

\_\_\_\_\_

Donation enclosed: £ \_\_\_\_\_

(Please make cheques payable to "Bodhi" and send to address below)

## GIFT AID IT

If you are a UK tax-payer, please consider ticking the GiftAid box below. At no extra cost to yourself, you are increasing your donation to Bodhi by 28%. Please note that by ticking this box you are agreeing with the following statement:

I wish the Bodhi Eco Project to claim back the tax on any donations from myself from 23/10/2006 until I notify you otherwise. I confirm that I am a UK tax-payer and have paid Income Tax or Capital Gains Tax at least equal to the amount Bodhi will claim back from the Inland Revenue.

\*please note that to claim Gift Aid we need your full name e.g. Jo Brown (rather than Mrs Brown), your house number and your postcode (NB c/o work addresses, sports centres etc mean we cannot claim back your Gift).

Signature \_\_\_\_\_

Date \_\_\_\_\_

Please note that your personal information will only be used to keep you informed about Bodhi events/news and will not be passed onto third parties (in accordance with the Data Protection Act 1998).

Please complete and send this form to:

**bodhi eco-project**  
(2/1) 14 Garrioch Drive,  
GLASGOW  
G20 8RS

**Registered Charity No. SCO37550**

## benefits for supporters

**As a Bodhi supporter you become an associate member and will:**

- Receive invitations to our meetings, retreats and events.
- Get information about our progress by regular news bulletins.
- Have access to our internet forum where you can post your ideas.
- Share the journey of creating the Bodhi village and perhaps living in it.

**Another step in reducing your ecological footprint!**

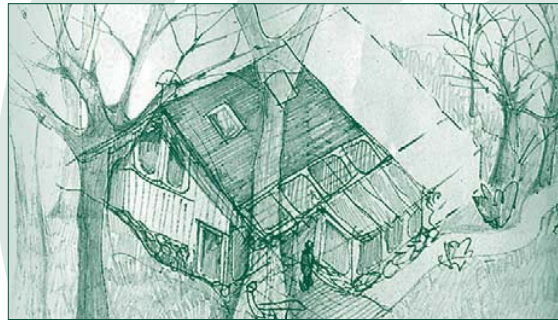

A partially dug-in house with solar panels

For further information contact:  
[info@bodhi-eco-project.org.uk](mailto:info@bodhi-eco-project.org.uk)

or visit our website:  
[www.bodhi-eco-project.org.uk](http://www.bodhi-eco-project.org.uk)



Supported by  
**The National Lottery**<sup>®</sup>  
through Awards for All



please recycle  
Printed on 100% recycled paper

designed by donna@ezppl.com

# bodhi

## eco-project



## mindful living

practice of ethics  
care for the earth  
creative arts

imagine creating a life together ...



- ♥ in an eco-village amidst the natural beauty of Scotland
- ♥ affordably owning/renting your eco-home on communally owned land/resources
- ♥ with others who are committed to a spiritual practice, developing kindness, generosity, honest communication and mindfulness in their daily lives
- ♥ in a predominately vegetarian village, growing some of our own food and conserving land and water
- ♥ with access to arts and crafts studio facilities and shared exhibition and performance spaces
- ♥ with minimum waste and carbon emissions and caring for the earth's resources through renewable energy systems
- ♥ with a shared transport system
- ♥ with people of all ages and from a diversity of life styles
- ♥ on the basis of consensus decision making
- ♥ sharing our experience with the wider community through work, education, and celebratory events

*together we can  
make this real!*



Some members of the core team

*"Never doubt that a small group of  
committed citizens can change the world."*

Margaret Mead

*"Be the change you want to see in the  
world."*

Gandhi

*"The best way to make your dreams come  
true is to wake up."*

Paul Valery



Residential bodhi-building weekend

where are we at?

Summer 2008 we are finalising the legal structures that will enable us to buy land. We are searching for and investigating sites in the central belt of Scotland, with the aim to purchasing a property by spring 2009.

Over the last year we received donations from 200 individual supporters and £8350 in grant awards. The interest continues to grow.

#### **Our current aims include:**

- Increasing our membership, especially young people
- Establishing an office base – employing a project manger; administrator; and education officer
- Carrying out site-specific feasibility studies
- Providing training in Permaculture, Non-violent Communication and Ecology
- Offering public talks
- Developing energy descent strategies

how can I get involved?

Whether you are attracted to living in the village or simply want to support the project, we greatly welcome your contributions of enthusiasm, experience, skills and money. To become a Bodhi supporter please complete the contribution form overleaf.

We have an ongoing programme of events where we would be delighted to meet you:

- Training events in permaculture, non-violent communication and ecology
- Retreats
- Festivals
- Talks
- Presentations/stands at large events